

Neoprene case included

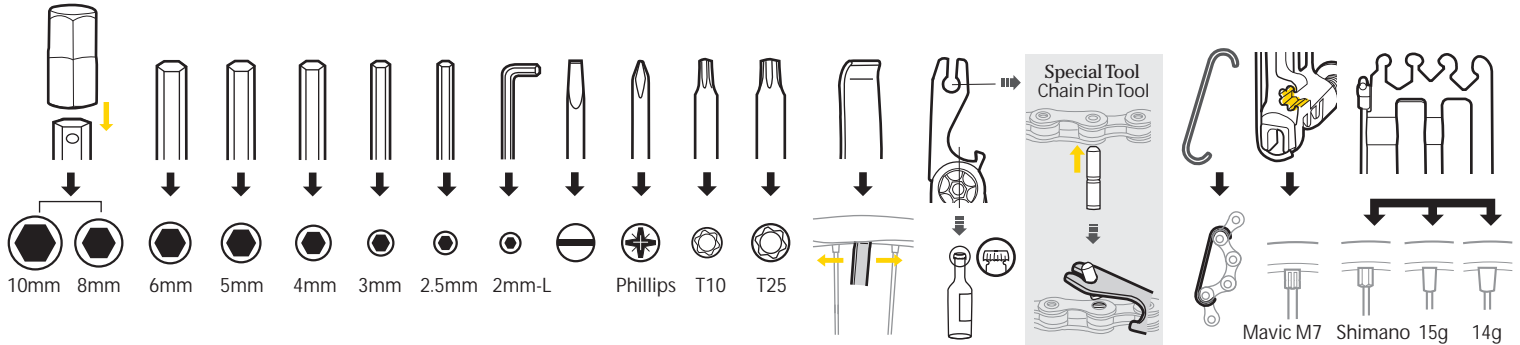

Using Chain Tool

Install new chain pin or remove old chain pin.

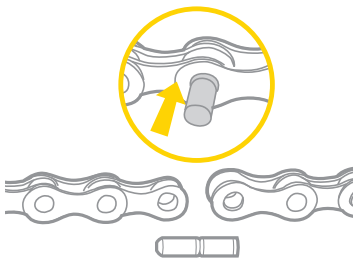

Primary Chain Link Fence Secondary Chain Link Fence

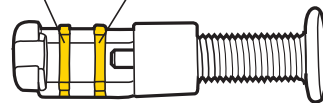

Use Primary Chain Link Fence to install or remove chain pin. Use Secondary Chain Link Fence to loosen stiff links.

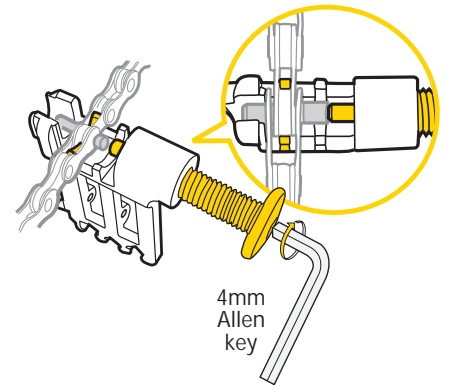

4mm Allen key

WARNING

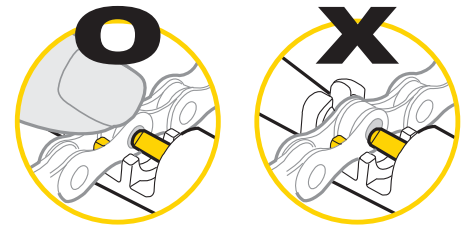

When pressing in the chain pin, push down on the top of the chain to keep it fully engaged in the chain tool cradle. Make sure the press pin of the chain tool is centered against the chain pin.

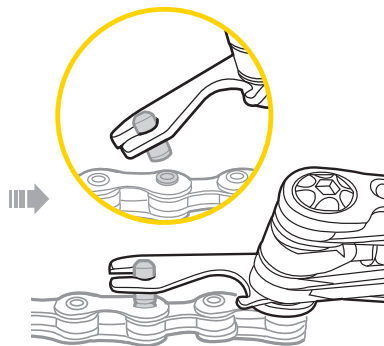
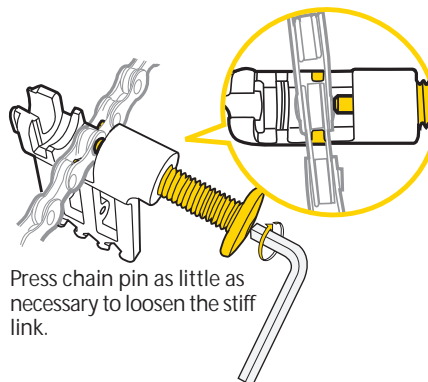
 Chain Pin Tool:
available in ALIEN II, ALIEN III,
Mini 18+ & Mini 20 pro

Press chain pin as little as necessary to loosen the stiff link.

Using Chain Hook and Chain Tool

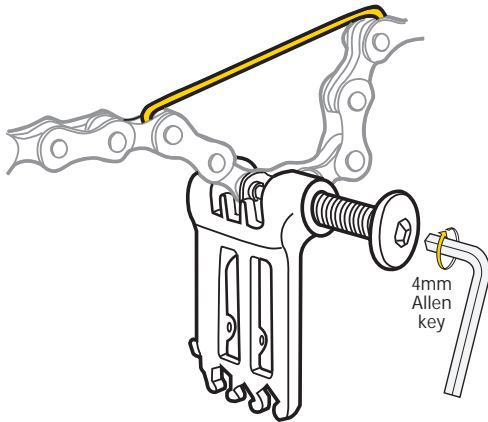

Tool maintenance

Using 3mm Allen key on chain tool to adjust the folding resistance.

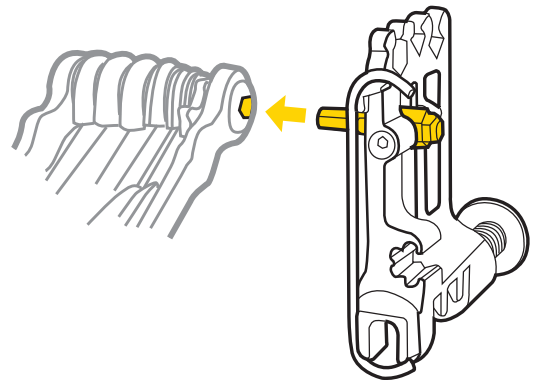

Spoke Wrenches for Marvic M7

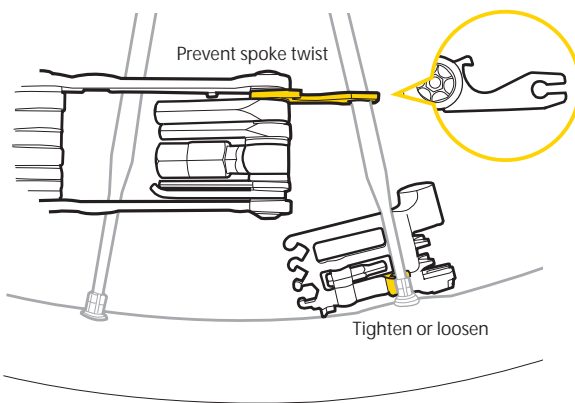

Using 8mm and 10mm Allen Keys

These two tools are combined.
Remove 10mm Allen head to use 8mm Allen key.

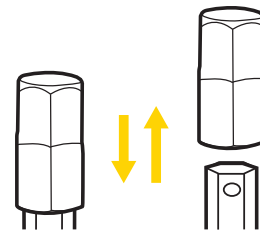

Using T25 Torx

Tighten disc brake rotor bolts with the T25 Torx wrench.



Using L Type 2mm Allen Key

Adjust brake lever reach bolts.

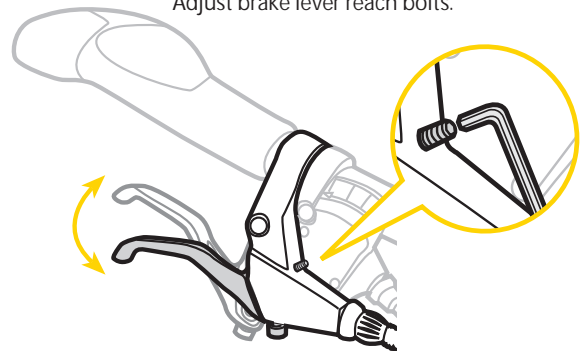

NOTE

1. Lubricate and maintain the tool with teflon based lubricant when needed. To prevent rusting, keep it dry.
2. The metal tire lever is designed for durability and for emergency use only. We recommend to use Topeak plastic tire levers, Shuttle Lever 1.1 or 1.2 for regular use and to prevent damage to carbon and alloy rim surfaces.
3. Compatible with all single speed and most multi-speed chains, including 10 speed hollow pin chain. (Not compatible with 11 speed chains.)

WARRANTY

2-year Warranty: All mechanical components against manufacturer defects only.

Warranty Claim Requirements

To obtain warranty service, you must have your original sales receipt. Items returned without a sales receipt will assume that the warranty begins on the date of manufacture. All warranties will be void if the product is damaged due to user abuse, tool or body alterations, modification, or used in any way not intended as described in this user's guide.

* The specifications and design are subject to change without notice.

Please contact your Topeak dealer with any questions.

For USA customer service call: 1-800-250-3068 Website: www.topeak.com